



Front and Rear Locking Differentials Installation Instructions

Covers Parts #8195

Kit contents:

- Differential assembly (2)
- Differential locking fork (2)
- T-Lock servos/servo mount assembly
- T-Lock cable (long)
- T-Lock cable (short)
- Ball cup (2)
- E-clips (2)
- 2.6x8mm BCS (2)
- 3x8mm BCS (2)
- High performance grease

Tools required:

- 2.0mm hex wrench
- Needle nose pliers

Installation

1. Remove the battery tray, all four wheels and tires, and the front and rear axle assemblies from the chassis.
2. Remove the portals from both ends of the front and rear inner axles.
3. Remove the differential covers and spools. **Retain and reuse the bearings from the spools.**
4. Remove the T-Lock cable plugs from the front and rear inner axle housings by removing the E-clips.
5. Install the bearings (**from step 3**) onto the differential assembly.
6. Place the differential assembly into the front axle housing (A). Apply a drop of the included high performance grease to the ring gear.
7. Assemble the locking fork to the short T-Lock cable (B).
8. Install the cable into the front axle housing and snap the locking fork onto the locking slider (C).
9. Secure the cable in the housing with an E-clip (D).
10. Repeat for the rear axle using the long T-Lock cable.
11. Route the T-Lock servo wires through the T-Lock servo mount as shown (E), then install the servos/servo mount assembly onto the chassis using the included 3x8mm BCS (2) (F).
12. Remove the receiver box cover. Route the servo wires through the wire clamp area of the receiver box and plug the wires into the receiver (front T-Lock servo to channel 4; rear T-Lock servo to channel 5). Bundle the wires into the receiver box (G). Reinstall the cover.
13. Screw a ball cup onto the front and rear T-Lock cables until all of the threads are hidden (H).
14. Snap the ball cups onto the T-Lock servo horns (I).
15. Install the T-Lock cables into the servo mount and secure with the 2.6x8mm BCS (2) (J).
16. Reinstall all removed parts, routing the T-Lock cables over the suspension link rods.

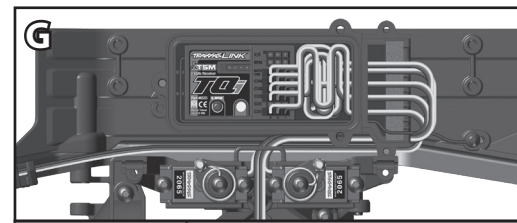
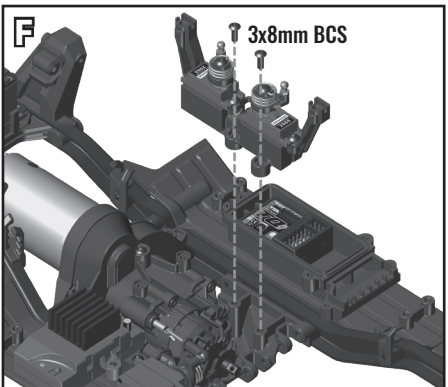
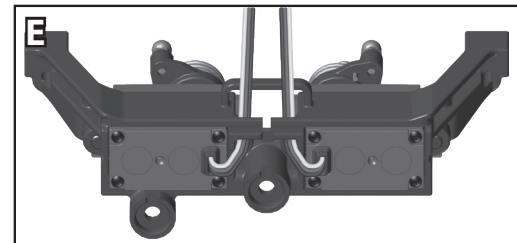
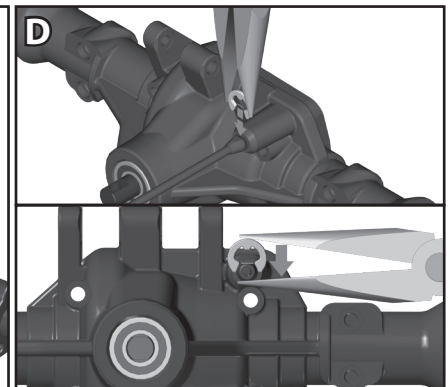
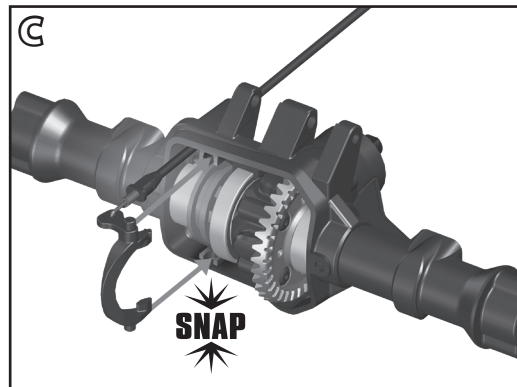
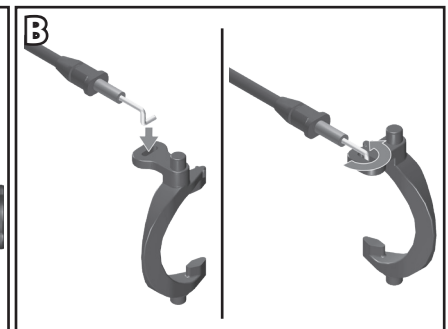
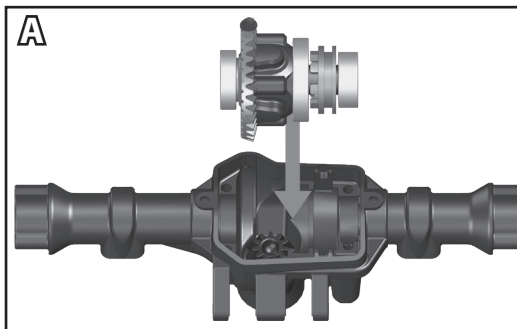

BATT/CH5	Rear T-Lock Servo
CH4	Front T-Lock Servo

